

Винты с потайной головкой под торцевой ключ    Материал: DIN 7991-10.9

**SM**

www.system.com.ru

| Номер d x L | L  | d   | k   | S   | d2 |
|-------------|----|-----|-----|-----|----|
| SM 3-10     | 10 | M3  | 1,7 | 2,0 | 6  |
| SM 3-12     | 12 | M3  | 1,7 | 2,0 | 6  |
| SM 3-16     | 16 | M3  | 1,7 | 2,0 | 6  |
| SM 3-20     | 20 | M3  | 1,7 | 2,0 | 6  |
| SM 3-25     | 25 | M3  | 1,7 | 2,0 | 6  |
| SM 3-30     | 30 | M3  | 1,7 | 2,0 | 6  |
| SM 4-8      | 8  | M4  | 2,3 | 2,5 | 8  |
| SM 4-10     | 10 | M4  | 2,3 | 2,5 | 8  |
| SM 4-12     | 12 | M4  | 2,3 | 2,5 | 8  |
| SM 4-16     | 16 | M4  | 2,3 | 2,5 | 8  |
| SM 4-20     | 20 | M4  | 2,3 | 2,5 | 8  |
| SM 4-25     | 25 | M4  | 2,3 | 2,5 | 8  |
| SM 4-30     | 30 | M4  | 2,3 | 2,5 | 8  |
| SM 5-10     | 10 | M5  | 2,8 | 3,0 | 10 |
| SM 5-12     | 12 | M5  | 2,8 | 3,0 | 10 |
| SM 5-16     | 16 | M5  | 2,8 | 3,0 | 10 |
| SM 5-20     | 20 | M5  | 2,8 | 3,0 | 10 |
| SM 5-25     | 25 | M5  | 2,8 | 3,0 | 10 |
| SM 5-30     | 30 | M5  | 2,8 | 3,0 | 10 |
| SM 5-40     | 40 | M5  | 2,8 | 3,0 | 10 |
| SM 6-10     | 10 | M6  | 3,3 | 4,0 | 12 |
| SM 6-12     | 12 | M6  | 3,3 | 4,0 | 12 |
| SM 6-16     | 16 | M6  | 3,3 | 4,0 | 12 |
| SM 6-20     | 20 | M6  | 3,3 | 4,0 | 12 |
| SM 6-25     | 25 | M6  | 3,3 | 4,0 | 12 |
| SM 6-30     | 30 | M6  | 3,3 | 4,0 | 12 |
| SM 6-35     | 35 | M6  | 3,3 | 4,0 | 12 |
| SM 6-40     | 40 | M6  | 3,3 | 4,0 | 12 |
| SM 8-16     | 16 | M8  | 4,4 | 5,0 | 16 |
| SM 8-20     | 20 | M8  | 4,4 | 5,0 | 16 |
| SM 8-25     | 25 | M8  | 4,4 | 5,0 | 16 |
| SM 8-30     | 30 | M8  | 4,4 | 5,0 | 16 |
| SM 8-35     | 35 | M8  | 4,4 | 5,0 | 16 |
| SM 8-40     | 40 | M8  | 4,4 | 5,0 | 16 |
| SM 8-45     | 45 | M8  | 4,4 | 5,0 | 16 |
| SM 8-50     | 50 | M8  | 4,4 | 5,0 | 16 |
| SM 10-16    | 16 | M10 | 5,5 | 6,0 | 20 |
| SM 10-20    | 20 | M10 | 5,5 | 6,0 | 20 |
| SM 10-25    | 25 | M10 | 5,5 | 6,0 | 20 |
| SM 10-30    | 30 | M10 | 5,5 | 6,0 | 20 |
| SM 10-35    | 35 | M10 | 5,5 | 6,0 | 20 |
| SM 10-40    | 40 | M10 | 5,5 | 6,0 | 20 |
| SM 10-45    | 45 | M10 | 5,5 | 6,0 | 20 |
| SM 10-50    | 50 | M10 | 5,5 | 6,0 | 20 |
| SM 12-20    | 20 | M12 | 6,5 | 8,0 | 24 |

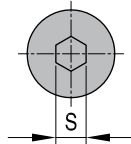
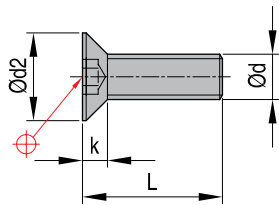