

Информация
d1 = Диаметр стержня
d2 = Диаметр головки
K = Толщина головки
L = Длина
Стандарт: DIN1530/ISO6751
Материал: сталь WAS (~1.2344), закаленная
Макс. темп.: 500-550 °C
Шероховатость: Ra

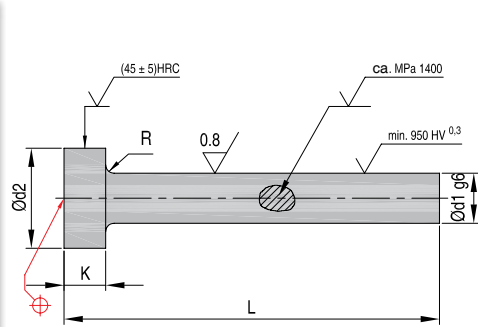

Код для заказа	Тип	d1 g6	d2 0 -0.2	K 0 -0.05	R +0.2 0	L ⁺² ₀															
						0100	0125	0160	0200	0250	0315	0400	0500	0630	0800	1000	1250				
ЕРА05 01-00 L	А	01,00	2,5	1,2	0,2																
ЕРА05 01-20 L		01,20	2,5	1,2	0,2																
ЕРА05 01-50 L		01,50	3,0	1,5	0,2																
ЕРА05 01-60 L		01,60	3,0	1,5	0,2																
ЕРА05 01-70 L		01,70	3,0	1,5	0,2																
ЕРА05 02-00 L		02,00	4,0	2,0	0,2																
ЕРА05 02-20 L		02,20	4,0	2,0	0,2																
ЕРА05 02-50 L		02,50	5,0	2,0	0,3																
ЕРА05 02-70 L		02,70	5,0	2,0	0,3																
ЕРА05 03-00 L		03,00	6,0	3,0	0,3																
ЕРА05 03-10 L		03,10	6,0	3,0	0,3																
ЕРА05 03-20 L		03,20	6,0	3,0	0,3																
ЕРА05 03-50 L		03,50	7,0	3,0	0,3																
ЕРА05 03-70 L		03,70	7,0	3,0	0,3																
ЕРА05 04-00 L		04,00	8,0	3,0	0,3																
ЕРА05 04-10 L		04,10	8,0	3,0	0,3																
ЕРА05 04-20 L		04,20	8,0	3,0	0,3																
ЕРА05 04-50 L		04,50	8,0	3,0	0,3																
ЕРА05 05-00 L		05,00	10,0	3,0	0,3																
ЕРА05 05-10 L		05,10	10,0	3,0	0,3																
ЕРА05 05-20 L		05,20	10,0	3,0	0,3																
ЕРА05 05-50 L		05,50	10,0	3,0	0,3																
ЕРА05 06-00 L		06,00	12,0	5,0	0,5																
ЕРА05 06-10 L		06,10	12,0	5,0	0,5																
ЕРА05 06-20 L		06,20	12,0	5,0	0,5																
ЕРА05 06-50 L		06,50	12,0	5,0	0,5																
ЕРА05 07-00 L		07,00	12,0	5,0	0,5																
ЕРА05 07-50 L		07,50	12,0	5,0	0,5																
ЕРА05 08-00 L		08,00	14,0	5,0	0,5																
ЕРА05 08-10 L		08,10	14,0	5,0	0,5																
ЕРА05 08-20 L		08,20	14,0	5,0	0,5																
ЕРА05 08-50 L		08,50	14,0	5,0	0,5																
ЕРА05 09-00 L		09,00	14,0	5,0	0,5																
ЕРА05 09-50 L		09,50	14,0	5,0	0,5																
ЕРА05 10-00 L		10,00	16,0	5,0	0,5																
ЕРА05 10-10 L		10,10	16,0	5,0	0,5																
ЕРА05 10-20 L		10,20	16,0	5,0	0,5																
ЕРА05 10-50 L		10,50	16,0	5,0	0,5																
ЕРА05 11-00 L		11,00	16,0	5,0	0,5																
ЕРА05 12-00 L		12,00	18,0	7,0	0,8																
ЕРА05 12-20 L	12,20	18,0	7,0	0,8																	
ЕРА05 12-50 L	12,50	18,0	7,0	0,8																	
ЕРА05 14-00 L	14,00	22,0	7,0	0,8																	
ЕРА05 14-20 L	14,20	22,0	7,0	0,8																	
ЕРА05 16-00 L	16,00	22,0	7,0	0,8																	
ЕРА05 18-00 L	18,00	24,0	7,0	0,8																	
ЕРА05 20-00 L	20,00	26,0	8,0	1,0																	
ЕРА05 25-00 L	25,00	32,0	8,0	1,0																	
ЕРА05 32-00 L	32,00	40,0	10,0	1,0																	

www.system.com.ru

CAD reference point